



Stringing Equipment

Machines and Tools for Overhead Power Lines

2016 Catalogue





Stringing Equipment

INDEX

Pullers

TY380	1010
TY280	1020
TY220	1021
TY180	1030
TY150	1031
TY120	1040
TY90	1050
TY60	1060
TY40	1070
TYZ800	1080
TYZ500	1090
TYZ280	1090
TYZ200	1090
TYS60	1091
TYDJ-50	1091

PULLERS

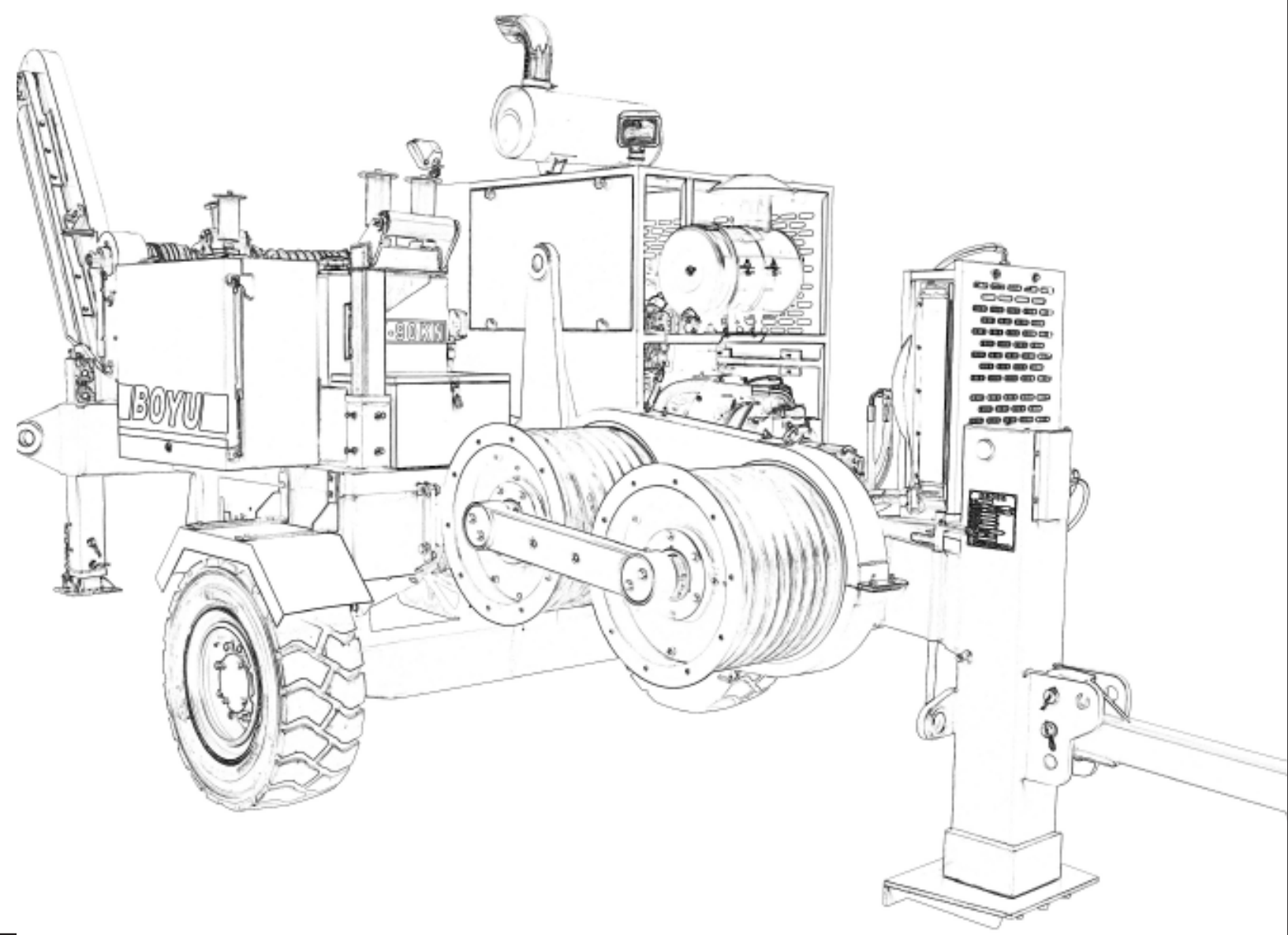

HYDRAULIC PULLER TY380

Boyu[®]



This machine is mainly applied in long-span and mountainous areas and foothills for tension stringing of 4-bundle conductor of 500kV or twin-bundle conductor of 220kV and conductor 800mm² below, allowing for the tension stringing of 500kV haulage rope in various terrains.

HYDRAULIC PULLERS

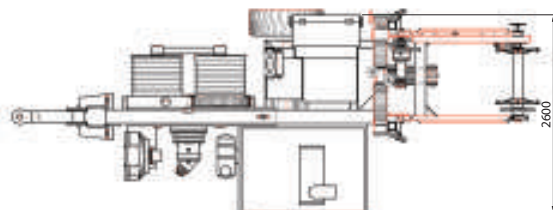
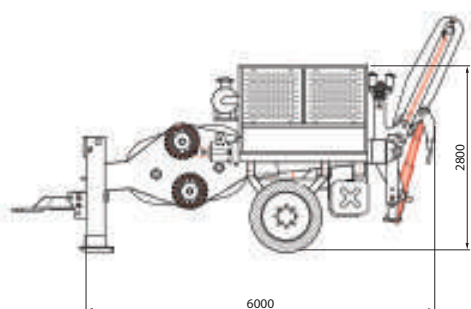

Performance

Max intermittent pull	380kN
Max continuous pull	350kN
Speed at max pull	2.5km/h
Max speed	5km/h
Pull at max speed	170kN

Engine

Diesel	440kw(590hp)
Cooling system	water
Electrical system	24V

Characteristics

Bull-wheel diameter	960mm
Groove number	11
Max rope diameter	38mm
Max diameter of coupling	100mm
Electric system	24V
Max diameter of rope reel	1900mm
Total weight	13600kg
Overall dimension	6000×2600×2800mm

Main configuration

Engine	Cummins
Main pump	German Rexroth
Main motor speed reducer	German Rexroth
Tail bracket hoisting motor	American Eton
Hydraulic meter	German WIKA
Operating handle	German Rexroth

Configuration

- Hydraulic dynamometer with set-point and automatic control of maximum pull
- Hydraulic oil cooling system
- Control instruments for hydraulic system and diesel engine
- On board reel winder with automatic level wind, suitable for standard reel mod. 1400 and 1900
- Hydraulic front stabilizer
- Grounding connection point

Hydraulic Transmission

Closed hydraulic circuit for step less speed variation in both rotating directions. This machine is provided with a pull pro-setting system that maintains the pre-set pulling value (also when the speed is reduced to "0") by automatically adjusting the operation speed according to the friction and unexpected loads which may occur.

Additional Devices

- Lighting system for the trailer
- Air brake system for the trailer
- Hydraulic rope clamp for reel change
- Swivel guide rope roller
- Trailer for towing at max speed of 30 km/h
- Extra shaft
- Digital speed and meter counter (extra charge)

Certified Quality System
ISO 9001:2008



1010

Keep you updated on
www.StringingEquipments.com

Yixing Boyu Electric Power Machinery Co.,Ltd.

Address: Hufu Town, Yixing City, Jiangsu 214200, China.
whatsapp and viber: 0086 18036062799

Overseas Development Department

Skype: hm-sales
E-mail: yxboyuh72@163.com

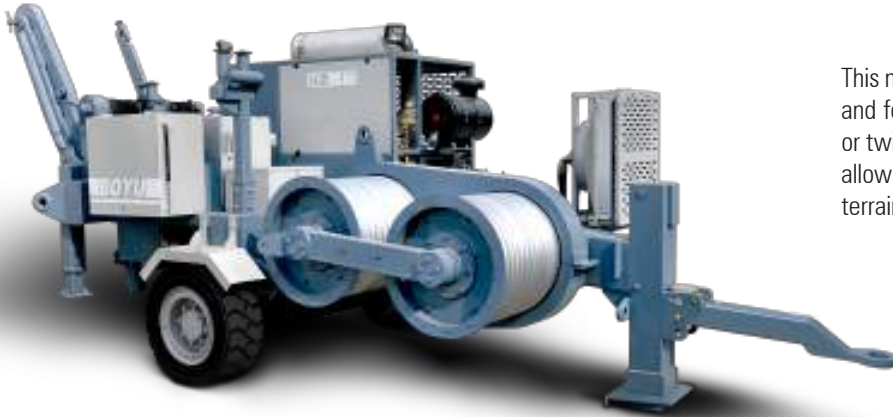

This machine is mainly applied in long-span and mountainous areas and foothills for tension stringing of 4-bundle conductor of 500kV or twin-bundle conductor of 220kV and conductor 800mm² below, allowing for the tension stringing of 500kV haulage rope in various terrains.

Performance

Max intermittent pull	280kN
Max continuous pull	250kN
Speed at max pull	2.5km/h
Max speed	5km/h
Pull at max speed	120kN

Engine

Diesel	298kw(400hp)
Cooling system	water
Electrical system	24V

Characteristics

Bull-wheel diameter	960mm
Groove number	11
Max rope diameter	38mm
Max diameter of coupling	100mm
Electric system	24V
Max diameter of rope reel	1600mm
Total weight	12800kg
Overall dimension	5800×2500×2850mm

Main configuration

Engine	Cummins
Main pump	German Rexroth
Main motor speed reducer	German Rexroth
Tail bracket hoisting motor	American Eton
Hydraulic meter	German WIKA
Operating handle	German Rexroth

Configuration

- Hydraulic dynamometer with set-point and automatic control of maximum pull
- Hydraulic oil cooling system
- Control instruments for hydraulic system and diesel engine
- On board reel winder with automatic level wind, suitable for standard reel mod. 1400 and 1600
- Hydraulic front stabilizer
- Grounding connection point

Hydraulic Transmission

Closed hydraulic circuit for step less speed variation in both rotating directions. This machine is provided with a pull pre-setting system that maintains the pre-set pulling value (also when the speed is reduced to "0") by automatically adjusting the operation speed according to the friction and unexpected loads which may occur.

Additional Devices

- Lighting system for the trailer
- Air brake system for the trailer
- Hydraulic rope clamp for reel change
- Swivel guide rope roller
- Trailer for towing at max speed of 30 km/h
- Extra shaft
- Digital speed and meter counter (extra charge)

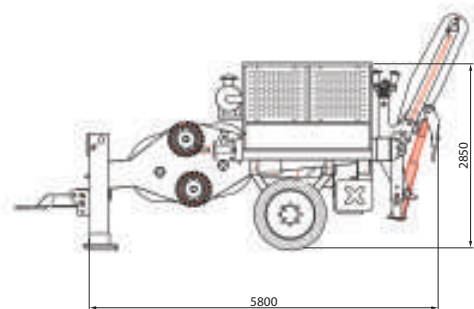

HYDRAULIC PULLER TY220

Boyu[®]



The machine allows for the tension stringing of 4-bundle conductor of 630mm² and below in mountainous and hilly areas, and of 4-bundle conductor of 720mm² and below in flat lands; besides, it can be used for traction stringing of OPGW or ADSS optical cable and 500kV traction stringing in various terrains.

HYDRAULIC PULLERS

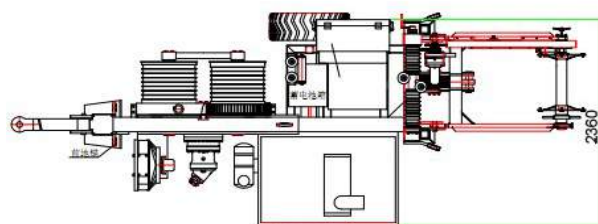
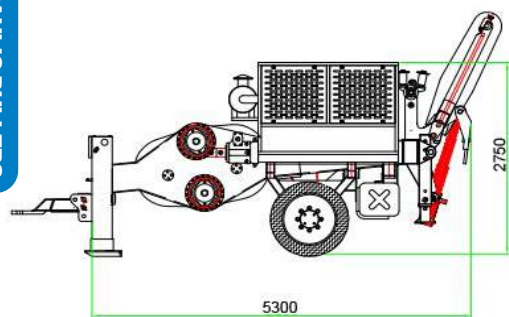

Performance

Max intermittent pull	220kN
Max continuous pull	180kN
Speed at max pull	2.5km/h
Max speed	5km/h
Pull at max speed	90kN

Engine

Diesel	239kw(320hp)
Cooling system	water
Electrical system	24V

Characteristics

Bull-wheel diameter	760mm
Groove number	10
Max rope diameter	30mm
Max diameter of coupling	100mm
Electric system	24V
Max diameter of rope reel	1600mm
Total weight	6800kg
Overall dimension	5300×2360×2750mm

Main configuration

Engine	Cummins
Main pump	German Rexroth
Main motor speed reducer	German Rexroth
Tail bracket hoisting motor	American Eton
Hydraulic meter	German WIKA
Operating handle	German Rexroth

Configuration

- Hydraulic dynamometer with set-point and automatic control of maximum pull
- Hydraulic oil cooling system
- Control instruments for hydraulic system and diesel engine
- On board reel winder with automatic level wind, suitable for standard reel mod. 1400 and 1600
- Hydraulic front stabilizer
- Grounding connection point

Hydraulic Transmission

Closed hydraulic circuit for step less speed variation in both rotating directions. This machine is provided with a pull pro-setting system that maintains the pre-set pulling value (also when the speed is reduced to "0") by automatically adjusting the operation speed according to the friction and unexpected loads which may occur.

Additional Devices

- Lighting system for the trailer
- Hydraulic rope clamp for reel change
- Swivel guide rope roller
- Trailer for towing at max speed of 30 km/h
- Extra shaft
- Digital speed and meter counter (extra charge)

Certified Quality System
ISO 9001:2008



1021

Keep you updated on
www.StringingEquipments.com

Yixing Boyu Electric Power Machinery Co.,Ltd.

Address: Hufu Town, Yixing City, Jiangsu 214200, China.
whatsapp and viber: 0086 18036062799

Overseas Development Department

Skype: hm-sales
E-mail: yxboyuh72@163.com

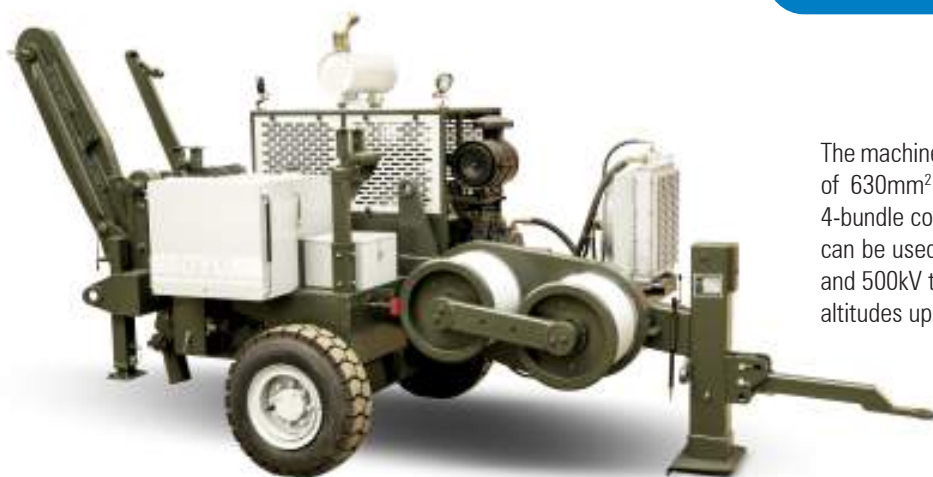

The machine allows for the tension stringing of 4-bundle conductor of 630mm² and below in mountainous and hilly areas, and of 4-bundle conductor of 720mm² and below in flat lands; besides, it can be used for traction stringing of OPGW or ADSS optical cable and 500kV traction stringing in various terrains, suitable for use at altitudes up to 1500 meters above sea level.

Performance

Max pull	190kN
Max continuous pull	180kN
Speed at max pull	2.5km/h
Max speed	6km/h
Pull at max speed	75kN

Engine

Diesel	325hp
Cooling system	liquid
Electrical system	24V

Characteristics

Bull-wheel diameter	750mm
Groove number	10
Max rope diameter	28mm
Max diameter of coupling	100mm
Electric system	24V
Max diameter of rope reel	1400mm
Total weight	6700kg
Overall dimension	5000x2300x2500mm

Main configuration

Engine	Cummins
Main pump	German Rexroth
Main motor speed reducer	German Rexroth
Tail bracket hoisting motor	American Eton
Hydraulic meter	German WIKA
Operating handle	German Rexroth

Configuration

- Hydraulic dynamometer with set-point and automatic control of maximum pull
- Hydraulic oil cooling system
- Control instruments for hydraulic system and diesel engine
- On board reel winder with automatic level wind, suitable for standard reel mod. 1100 and 1400
- Hydraulic front stabilizer
- Grounding connection point

Hydraulic Transmission

Closed hydraulic circuit for step less speed variation in both rotating directions. This machine is provided with a pull pre-setting system that maintains the pre-set pulling value (also when the speed is reduced to "0") by automatically adjusting the operation speed according to the friction and unexpected loads which may occur.

Additional Devices

- Lighting system for the trailer
- Hydraulic rope clamp for reel change
- Swivel guide rope roller
- Trailer for towing at max speed of 30 km/h
- Extra shaft
- Digital speed and meter counter (extra charge)

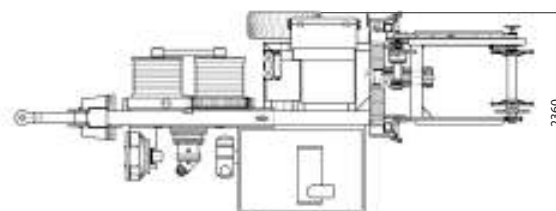
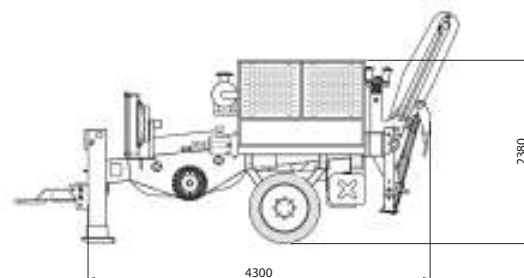

HYDRAULIC PULLER TY150

Boyu[®]



The machine allows for the tension stringing of 4-bundle conductor of 630mm² and below in mountainous and hilly areas, and of 4-bundle conductor of 720mm² and below in flat lands; besides, it can be used for traction stringing of OPGW or ADSS optical cable and 500kV traction stringing in various terrains.

HYDRAULIC PULLERS

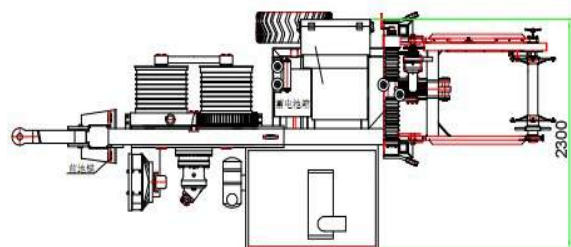
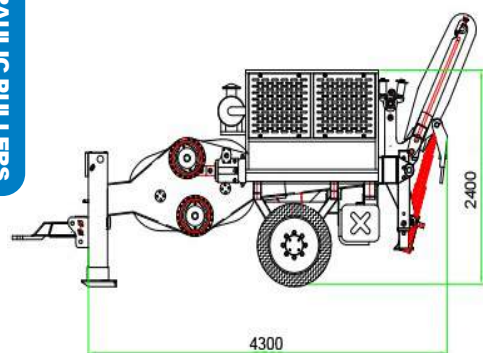

Performance

Max intermittent pull	150kN
Max continuous pull	120kN
Speed at max pull	2.5km/h
Max speed	5km/h
Pull at max speed	60kN

Engine

Diesel	129kw(173hp)
Cooling system	water
Electrical system	24V

Characteristics

Bull-wheel diameter	600mm
Groove number	10
Max rope diameter	24mm
Max diameter of coupling	100mm
Electric system	24V
Max diameter of rope reel	1600mm
Total weight	5500kg
Overall dimension	4300×2300×2400mm

Main configuration

Engine	Cummins
Main pump	German Rexroth
Main motor speed reducer	German Rexroth
Tail bracket hoisting motor	American Eton
Hydraulic meter	German WIKA
Operating handle	German Rexroth

Configuration

- Hydraulic dynamometer with set-point and automatic control of maximum pull
- Hydraulic oil cooling system
- Control instruments for hydraulic system and diesel engine
- On board reel winder with automatic level wind, suitable for standard reel mod. 1400 and 1600
- Hydraulic front stabilizer
- Grounding connection point

Hydraulic Transmission

Closed hydraulic circuit for step less speed variation in both rotating directions. This machine is provided with a pull pro-setting system that maintains the pre-set pulling value (also when the speed is reduced to "0") by automatically adjusting the operation speed according to the friction and unexpected loads which may occur.

Additional Devices

- Lighting system for the trailer
- Hydraulic rope clamp for reel change
- Swivel guide rope roller
- Trailer for towing at max speed of 30 km/h
- Extra shaft
- Digital speed and meter counter (extra charge)

Certified Quality System
ISO 9001:2008



1031

Keep you updated on
www.StringingEquipments.com

Yixing Boyu Electric Power Machinery Co.,Ltd.

Address: Hufu Town, Yixing City, Jiangsu 214200, China.
whatsapp and viber: 0086 18036062799

Overseas Development Department

Skype: hm-sales
E-mail: yxboyuh72@163.com



The machine allows for the tension stringing of 4-bundle conductor of 630mm² and below in mountainous and hilly areas, and of 4-bundle conductor of 720mm² and below in flat lands; besides, it can be used for traction stringing of OPGW or ADSS optical cable and 500kV traction stringing in various terrains.

Performance

Max intermittent pull	120kN
Max continuous pull	100kN
Speed at max pull	2.5km/h
Max speed	5km/h
Pull at max speed	50kN

Engine

Diesel	129kw(173hp)
Cooling system	water
Electrical system	24V

Characteristics

Bull-wheel diameter	600mm
Groove number	10
Max rope diameter	24mm
Max diameter of rope reel	1400mm
Total weight	4800kg
Overall dimension	4000×2300×2300mm

Main configuration

Engine	Cummins
Main pump	German Rexroth
Main motor	German Rexroth
Speed reducer	German Rexroth
Tail bracket hoisting motor	American Eton
Hydraulic meter	German WIKA
Operating handle	German Rexroth

Configuration

- Hydraulic dynamometer with set-point and automatic control of maximum pull
- Hydraulic oil cooling system
- Control instruments for hydraulic system and diesel engine
- On board reel winder with automatic level wind, suitable for standard reel mod. 1100 and 1400
- Hydraulic front stabilizer
- Grounding connection point

Hydraulic Transmission

Closed hydraulic circuit for step less speed variation in both rotating directions. This machine is provided with a pull pre-setting system that maintains the pre-set pulling value (also when the speed is reduced to "0") by automatically adjusting the operation speed according to the friction and unexpected loads which may occur.

Additional Devices

- Lighting system for the trailer
- Hydraulic rope clamp for reel change
- Swivel guide rope roller
- Trailer for towing at max speed of 30 km/h
- Extra shaft
- Digital speed and meter counter (extra charge)

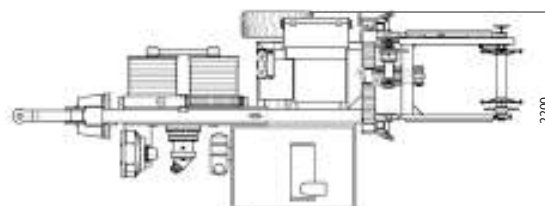
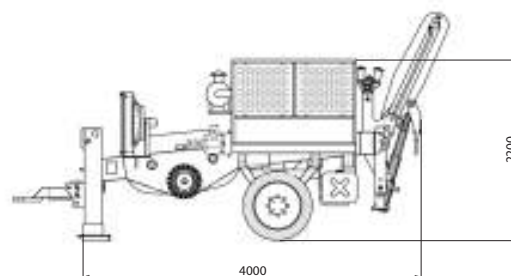

HYDRAULIC PULLER TY90

Boyu[®]



This machine allows for the tension stringing of twin-bundle conductor of 500mm² and below in mountainous and hilly areas, of twin-bundle conductor of 630mm² and below in flat lands, and of single conductor 720mm² in various terrains; besides, it can be used for traction stringing of OPGW or ADSS optical cable and 220kV haulage rope in various terrains.

HYDRAULIC PULLERS

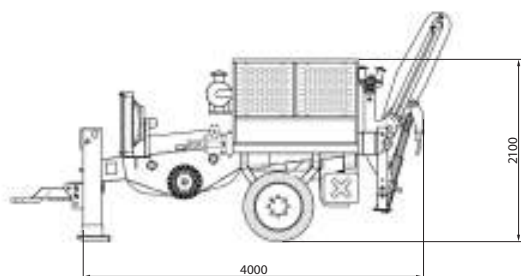

Performance

Max pull	100kN
Max continuous pull	90kN
Speed at max pull	2.5km/h
Max speed	5km/h
Pull at max speed	40kN

Engine

Diesel	118kw(158hp)
Cooling system	liquid
Electrical system	24V

Characteristics

Bull-wheel diameter	540mm
Groove number	8
Max rope diameter	21mm
Max diameter of rope reel	1400mm
Total weight	4350kg
Overall dimension	4500×2100×2450mm

Main configuration

Engine	Cummins
Main pump	German Rexroth
Main motor speed reducer	German Rexroth
Tail bracket hoisting motor	American Eton
Hydraulic meter	German WIKA
Operating handle	German Rexroth

Configuration

- Hydraulic dynamometer with set-point and automatic control of maximum pull
- Hydraulic oil cooling system
- Control instruments for hydraulic system and diesel engine
- On board reel winder with automatic level wind, suitable for standard reel mod. 1100 and 1400
- Hydraulic front stabilizer
- Grounding connection point

Hydraulic Transmission

Closed hydraulic circuit for step less speed variation in both rotating directions. This machine is provided with a pull pre-setting system that maintains the pre-set pulling value (also when the speed is reduced to "0") by automatically adjusting the operation speed according to the friction and unexpected loads which may occur.

Additional Devices

- Lighting system for the trailer
- Hydraulic rope clamp for reel change
- Swivel guide rope roller
- Trailer for towing at max speed of 30 km/h
- Extra shaft
- Digital speed and meter counter (extra charge)

Certified Quality System
ISO 9001:2008



1050

Keep you updated on
www.StringingEquipments.com

Yixing Boyu Electric Power Machinery Co.,Ltd.

Address: Hufu Town, Yixing City, Jiangsu 214200, China.
whatsapp and viber: 0086 18036062799

Overseas Development Department

Skype: hm-sales
E-mail: yxboyuh72@163.com



Together with tension machine, this model allows for the tension stringing of 220kV lines in mountainous and hilly areas and can be used for the traction stringing of OPGW or ADSS cable in various terrains.

Performance

Max intermittent pull	60kN
Max continuous pull	50kN
Speed at max pull	2.5km/h
Max speed	5km/h
Pull at max speed	25kN

Engine

Diesel	77kw(103hp)
Cooling system	water
Electrical system	24V

Characteristics

Bull-wheel diameter	450mm
Groove number	7
Max rope diameter	18mm
Max diameter of rope reel	1400mm
Total weight	3500kg
Overall dimension	3800×2100×2300mm

Main configuration

Engine	Cummins
Main pump	German Rexroth
Main motor speed reducer	German Rexroth
Tail bracket hoisting motor	American Eton
Hydraulic meter	German WIKA
Operating handle	German Rexroth

Configuration

- Hydraulic dynamometer with set-point and automatic control of maximum pull
- Hydraulic oil cooling system
- Control instruments for hydraulic system and diesel engine
- On board reel winder with automatic level wind, suitable for standard reel mod. 1100 and 1400
- Hydraulic front stabilizer
- Grounding connection point

Hydraulic Transmission

Closed hydraulic circuit for step less speed variation in both rotating directions. This machine is provided with a pull pro-setting system that maintains the pre-set pulling value (also when the speed is reduced to "0") by automatically adjusting the operation speed according to the friction and unexpected loads which may occur.

Additional Devices

- Lighting system for the trailer
- Hydraulic rope clamp for reel change
- Swivel guide rope roller
- Trailer for towing at max speed of 30 km/h
- Extra shaft
- Digital speed and meter counter (extra charge)

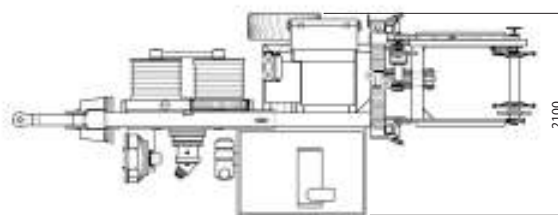
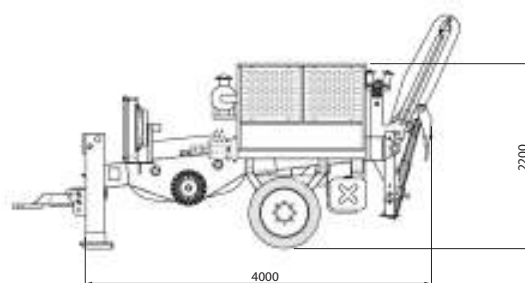

HYDRAULIC PULLER TY40

Boyu[®]

Together with tension machine, this model allows for the tension stringing of 220kV lines in mountainous and hilly areas and can be used for the traction stringing of OPGW or ADSS cable in various terrains.



HYDRAULIC PULLERS

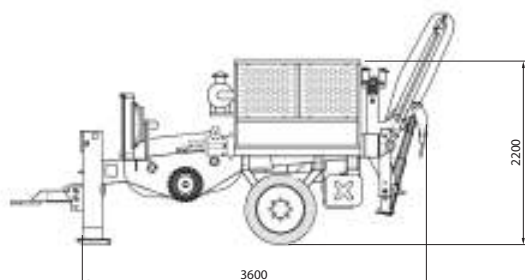

Performance

Max intermittent pull	40kN
Max continuous pull	30kN
Speed at max pull	2.5km/h
Max speed	5km/h
Pull at max speed	20kN

Engine

Diesel	77kw(103hp)
Cooling system	water
Electrical system	24V

Characteristics

Bull-wheel diameter	400mm
Groove number	7
Max rope diameter	16mm
Max diameter of rope reel	1200mm
Total weight	3000kg
Overall dimension	3600×2600×2200mm

Main configuration

Engine	Cummins
Main pump	German Rexroth
Main motor speed reducer	German Rexroth
Tail bracket hoisting motor	American Eton
Hydraulic meter	German WIKA
Operating handle	German Rexroth

Configuration

- Hydraulic dynamometer with set-point and automatic control of maximum pull
- Hydraulic oil cooling system
- Control instruments for hydraulic system and diesel engine
- On board reel winder with automatic level wind, suitable for standard reel mod. 1100 and 1200
- Manual front stabilizer
- Grounding connection point

Hydraulic Transmission

Closed hydraulic circuit for step less speed variation in both rotating directions. This machine is provided with a pull pre-setting system that maintains the pre-set pulling value (also when the speed is reduced to "0") by automatically adjusting the operation speed according to the friction and unexpected loads which may occur.

Additional Devices

- Lighting system for the trailer
- Hydraulic rope clamp for reel change
- Swivel guide rope roller
- Trailer for towing at max speed of 30 km/h
- Extra shaft
- Digital speed and meter counter (extra charge)

Certified Quality System
ISO 9001:2008



1070

Keep you updated on
www.StringingEquipments.com

Yixing Boyu Electric Power Machinery Co.,Ltd.

Address: Hufu Town, Yixing City, Jiangsu 214200, China.
whatsapp and viber: 0086 18036062799

Overseas Development Department

Skype: hm-sales
E-mail: yxboyuh72@163.com



Tractor Puller TYZ800

Modified from JDT8002 tractor of John Deerer Tianjing Tractor Co., Ltd., this mechanically driven machine has the advantages such as simple operation, high tractive force, fast speed and easy maintenance, making it not only a good choice for pole setting, tower erecting and stringing in construction but also an ideal tool for traction or tension stringing of conductors below 630mm². The machine can also be provided with take-up and winding device as required by the user.

Performance

Gear	Low gear1	Low gear2	Low gear3	Low gear4	Low gear5	Slow down
Pulling force (KN)	80	65	55	35	20	
Speed (m/min)	15.6	19	23	43	65	14

Characteristics

Puller wheel diameter	450mm
Groove number	8
Max diameter of applicable steel wire rope	18mm
Total weight	4300kgs
Overall dimension (length×width×height)	4050×2150×2690mm



TYRV Reel Hydraulic Winders



The reel winders are suitable to work with any hydraulic power unit, in particular with pullers and puller-tensioners, and operate as separated winding systems. They are equipped with automatic level wind and negative self-acting hydraulic brake. The frame is made of welded steel with protective coating. The reel winders can lift the reel by hydraulic jacks powered by the same hydraulic source.

Characteristics

Max rope diameter	20mm
Max diameter of rope reel	1600mm
Total weight	450kg
Overall dimension	2200×1700×700mm

Main configuration

Hydraulic motor	Italy Sauer-Danfoss
Hydraulic meter	German WIKA
Hydraulic valve	Japan Yuken

TRACTOR PULLER TYZ550 / TYZ280 / TYZ200



HYDRAULIC PULLERS

Tractor Puller TYZ550

This mechanically driven machine has the advantages such as simple operation, high tractive force and fast speed, making it not only a good choice for pole setting, tower erecting and stringing in construction but also an ideal tool for long-distance traction or tension stringing.



Performance

Gear	1	2	3	4	5	6	Reverse1	Reverse2
Pulling Force (kN)	55	30.6	16.2	12.7	7.7	4		
Pulling Speed (m/min)	10.13	16.65	31.55	40	66.61	126.3	13.34	50.3

Characteristics

Puller wheel diameter	325mm
Groove number	6
Max diameter of applicable steel wire rope	16mm
Total weight	2260kgs
Overall dimension (length×width×height)	3360×1750×2320mm

Tractor Puller TYZ280

Together with tension machine, this model allows for the traction and tension stringing of 110kV lines in mountainous and hilly areas and can be used for the traction stringing of OPGW or ADSS cable in various terrains.



Performance

Gear	1	2	3	4	5	6	7	8	Reverse1	Reverse2
Pulling Force (kN)	45	36	22	14	10.5	8.3	5.1	2.8		
Pulling Speed (m/min)	10.5	13.3	21.7	34.4	45.4	57.4	93.4	166.6	9.8	42.5

Characteristics

Puller wheel diameter	325mm
Groove number	6
Max diameter of applicable steel wire rope	16mm
Total weight	1800kgs
Overall dimension (length×width×height)	2974×1380×1438mm

Tractor Puller TYZ200

Modified from 200-tractor, this automatically driven machine has the advantages such as easy transfer between construction sites as complete with a trailer; reliable breaking ensured by ground handling; and stable integrity and reduced tire pressure under the effect of traction as provided with auxiliary support. It can be used in the construction of lines below 110kV for local power supply department and is an ideal tool of provincial power transmission and distribution companies for tower erecting, porcelain insulator installing and stringing.

Performance

Gear	1	2	3	4	5	6	Reverse
Pulling Force (kN)	41	18.2	13.7	11.7	5.9	3.6	
Pulling Speed (m/min)	5.2	12	16	19	37	59	12

Characteristics

Puller wheel diameter	252or 320mm
Groove number	6
Max diameter of applicable steel wire rope	13mm
Total weight	1280kgs
Overall dimension (length×width×height)	2660×1360×1310mm



(without reel winder)

1090

Keep you updated on
www.StringingEquipments.com

Yixing Boyu Electric Power Machinery Co.,Ltd.

Address: Hufu Town, Yixing City, Jiangsu 214200, China.
whatsapp and viber: 0086 18036062799

Overseas Development Department

Skype: hm-sales
E-mail: yxboyuh72@163.com

TYS60 Cableway Hydraulic Puller

The machine is divided into power unit, control system and traction device. Each part weights less than 1 ton. It has small volume, light weight and is easy for transport. It is suit for construction of the mountain.

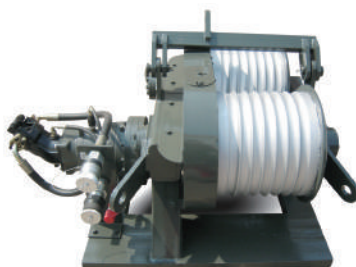
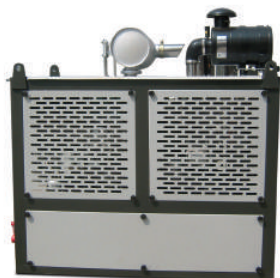

Characteristics

Bull-wheel diameter	350mm
Groove number	7
Groove width	37mm
Max rope diameter	18mm
Electric system	24V
Total weight	2000kg
Overall dimension (length*width*height)	
1700mm*870mm*1200mm (power)	
1700mm*830mm*1000mm (control)	
1000mm*880mm*700mm (puller)	

Performance

Max intermittent pull	60kN
Max continuous pull	50kN
Speed at max pull	2.5km/h
Max speed	5km/h
Pull at max speed	25kN

Engine

Diesel	77kw(103hp)
Cooling system	water
Electrical system	24V

Main configuration

Engine	Cummins
Main pump	German Rexroth
Main motor speed reducer	German Rexroth
Hydraulic meter	German WIKA
Hydraulic valve	Italy ATOS
Quick coupling	Italy STUCCHI

TYDJ Cableway Puller



Cableway puller TYDJ is a kind of engineering machinery specially designed to the requirements of the cableway transportation construction. It is a kind of ideal puller equipment for freight aero tramway in the wild mountain with no power.

Performance

Model	Gear	Rope speed (meter/min)	Pull force (kN)	Rated power (kw)	Rated speed (round/min)	Flow (g/(kg*h))	Direction of Rotation
TYDJ-50	Drive	I 16	50	18	2300	≤374	CCW
		II 37	22				
		III 67	13				
	Reverse	I 15.6	50	18	2300	≤374	CCW
		II 36	22				
		III 65	13				



TYDQ40 Hydraulic Winches

The machine is suitable for the underground cable laying drawing operations

Performance

Max pull	40kN
Speed	0~12m/min

Engine

Diesel	24hp
Speed	2000rpm

Characteristics

Steel wire diameter	11mm
Length	650m
Total weight	2000kg
Overall dimension	3670×1600×1650mm